

APPLICATIONS
Chrysler Sebring 2007
Dodge Avenger 2007-2008
Dodge Nitro 2007

Jeep Wrangler 2007
(Modifications To Radio Cavity Required)

12.301035-06

KIT FEATURES

- Double DIN Radio Provision
- Stacked ISO Units Provision



KIT COMPONENTS

A) Double DIN Brackets/Trim Plates

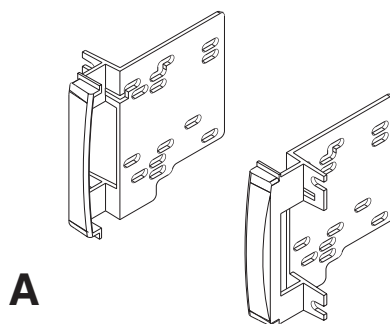

TOOLS REQUIRED:

Small Flat Blade Screwdriver/ Panel Removal Tool
• Phillips Screwdriver • Socket Set



TABLE OF CONTENTS

Dash Disassembly

- Chrysler Sebring 2007	1
- Dodge Avenger 2007-2008	2
- Dodge Nitro 2007	3
- Jeep Wrangler 2007 (Modifications to radio cavity required)	4

Kit Assembly

- Double DIN Radio Provision	5
- Stacked ISO Units Provision	6

<u>Final Assembly</u>	7
------------------------------------	----------

***Note:**

Refer also to the instructions included with the aftermarket radio.

CHRYSLER SEBRING 2007

- 1** Disconnect the negative battery terminal to prevent an accidental short circuit.
- 2** Unclip entire panel surrounding radio including a/c vents and clock. Unplug and remove panel. (Figure A)
- 3** Remove (4) 7MM screws securing radio. Unplug and remove radio. (Figure B)

Continue to kit assembly.

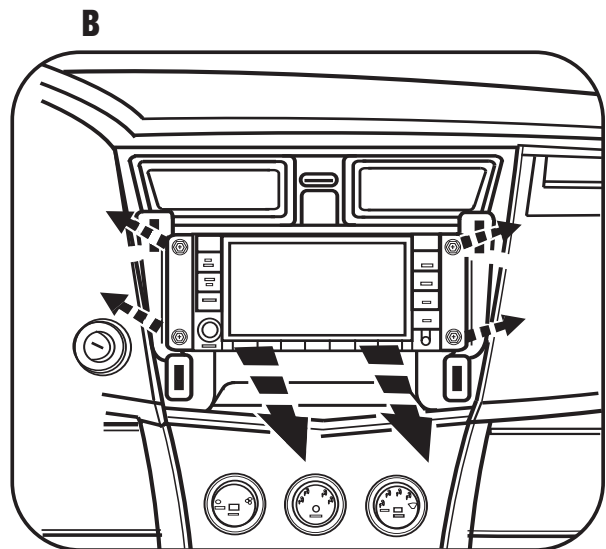
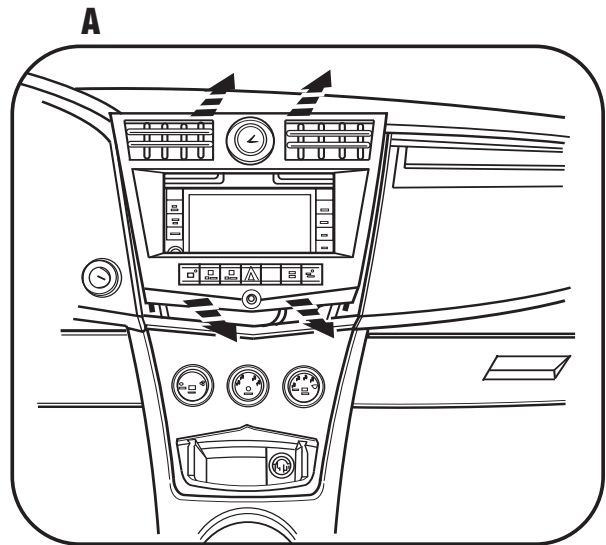

DODGE AVENGER 2007-2008

- 1** Disconnect the negative battery terminal to prevent an accidental short circuit.
- 2** Unclip and remove the center console trim panel. (Figure A)
- 3** Unclip the center dash trim panel. (Figure B)
- 4** Remove (4) screws securing the radio. Disconnect and remove the radio. (Figure C)
- 5** Remove (3) screws securing the radio rear support bracket and remove the bracket. (Figure D)

Continue to kit assembly.

A

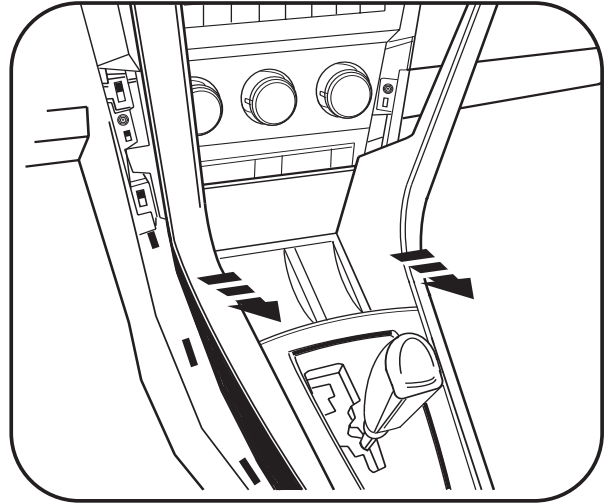

B

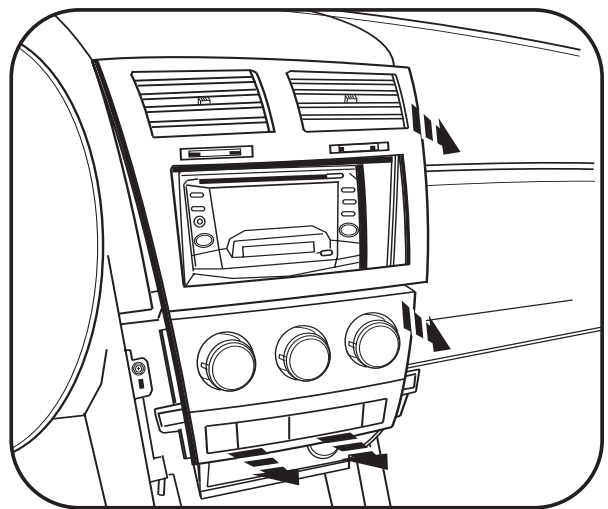

C

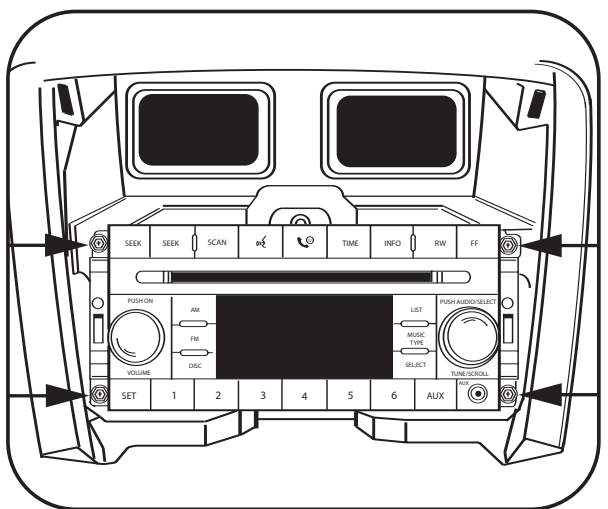

D

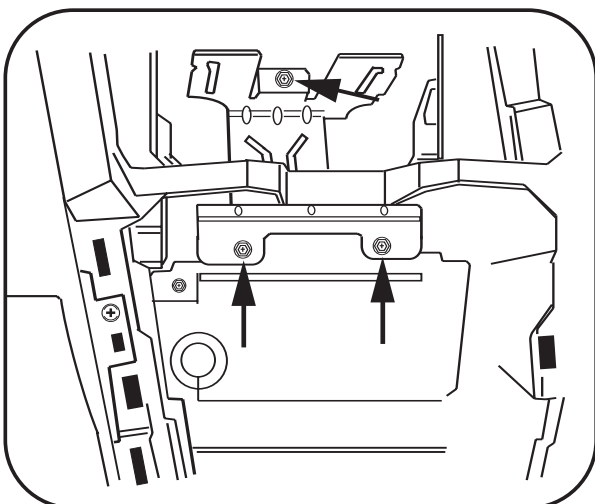

DODGE NITRO 2007

- 1** Disconnect the negative battery terminal to prevent an accidental short circuit.
- 2** Unclip entire panel surrounding radio and climate controls, including a/c vents. Unplug and remove panel.
- 3** Remove (4) 7MM screws securing radio. Unplug and remove radio. (Figure B)

Continue to kit assembly.

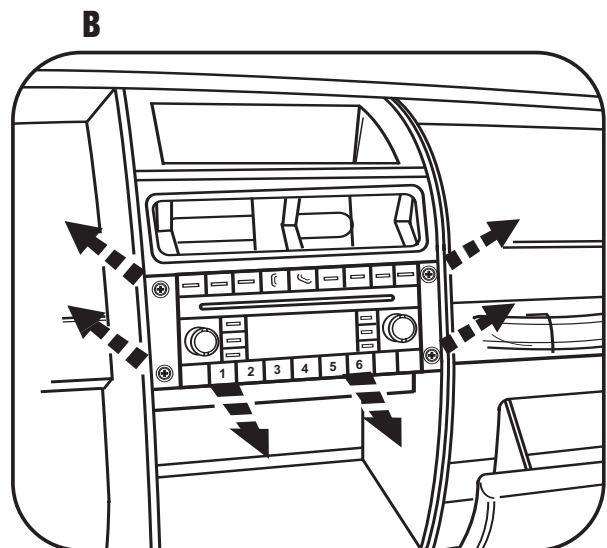
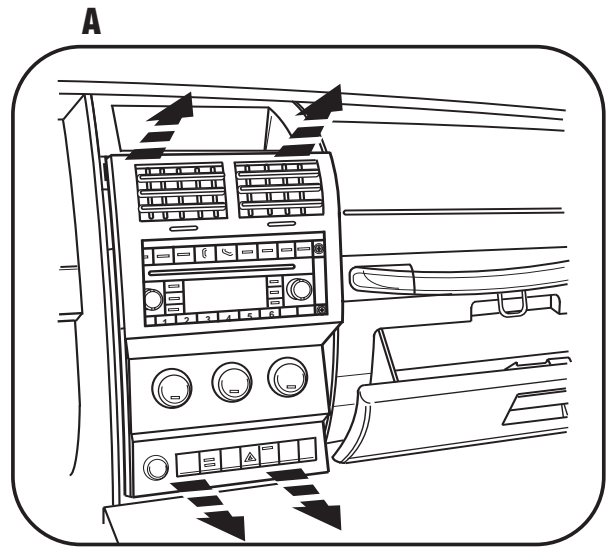

JEEP WRANGLER 2007

(Modifications To Radio Cavity Required)

- 1** Disconnect the negative battery terminal to prevent an accidental short circuit.
- 2** Unclip and remove the lower center trim below a/c controls. (Figure A)
- 3** Remove (2) Phillips screws exposed behind lower center panel. (Figure A)
- 4** Unclip and remove the upper center trim starting towards the rear of the panel. (Figure A)
- 5** Remove (2) Phillips screws exposed behind upper center panel. (Figure A)
- 6** Unclip and remove entire panel surrounding radio and climate controls, including a/c vents.
- 7** Remove (4) 7MM screws securing radio. Unplug and remove radio. (Figure B)

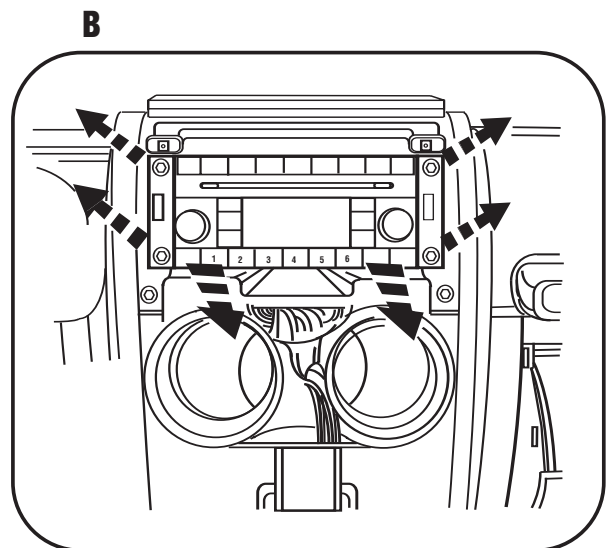
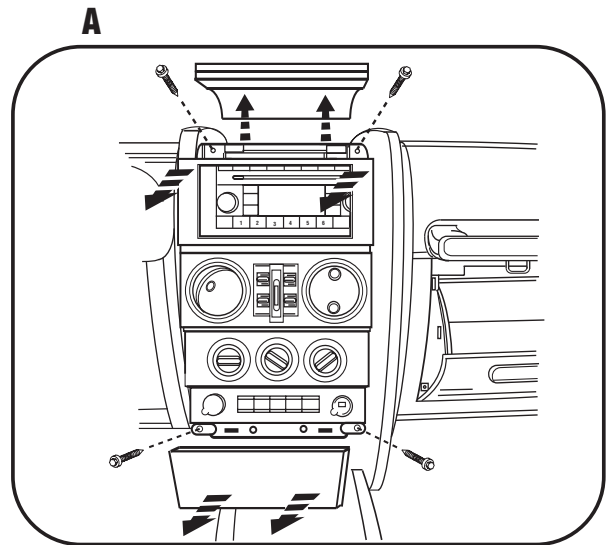

Continue to kit assembly.

DOUBLE DIN RADIO PROVISION

**Note: Refer also to the instructions included with the aftermarket radio.*

- 1 Attach the Double DIN brackets/trim plates to the Double DIN Radio using the screws supplied with the Radio. (Figure A)

Continue to final assembly.

